

BMW Aerodynamic Research Centre, Munich



Shop Building and Wind Channel

Client: BMW Group **Main Contractor :** Leonhard Weiss GmbH & Co.KG

Architects: Ackermann & Partner

Scope:

- CW-Elements
- Alucobond cladding
- Doors
- Windows
- Sectional gates
- Stick-systems
- Steel canopies
- M&E plant louvres

Design Tasks:

- General Contractors consultancy and price estimating
- Building façade supply-chain management
- Design definition and engineering
- Structural calculations
- Approval drawings
- Workshop drawings

BMW wind-tunnel overview. Group 5F to define scope for price estimating. There are 8500 curved and right- angle sheet metal units to be defined for production.



Typical horizontal section of a unit

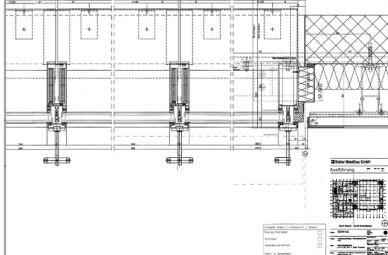

BMW shop building at construction site



BMW shop building at construction site

